

FD 2870-30

CONTI® Double Convolution Air Spring

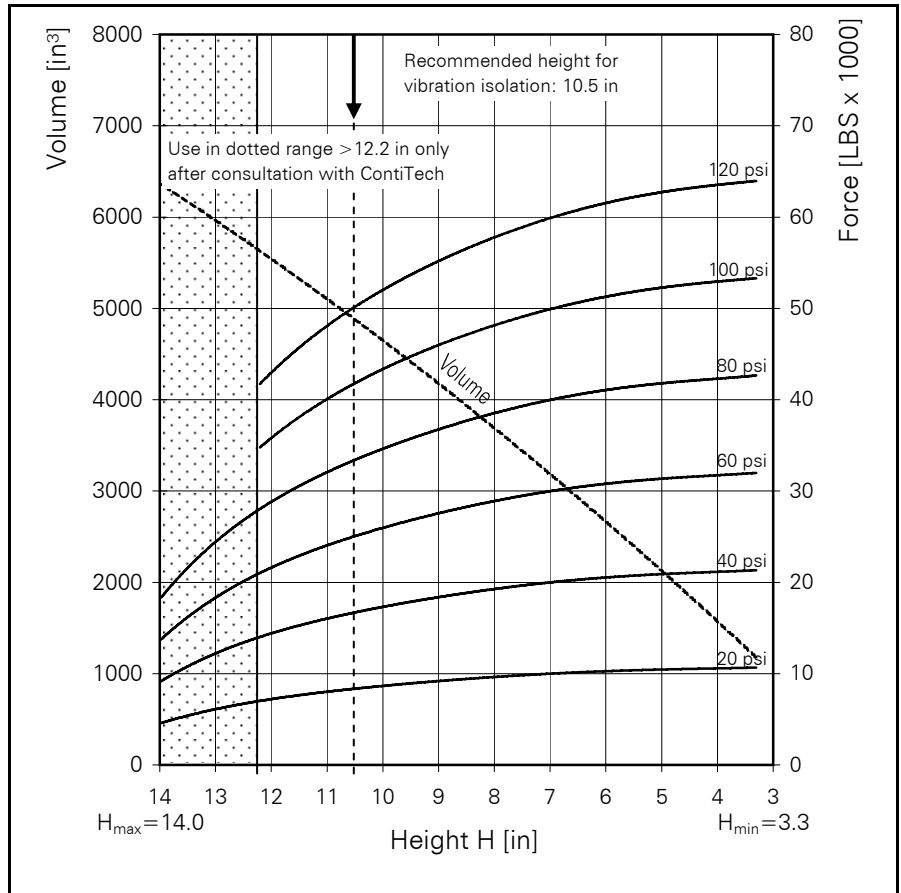
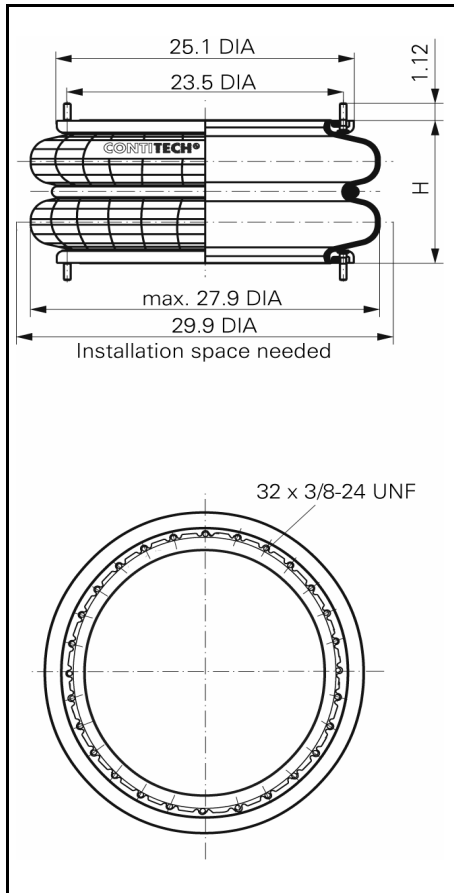

FD 2870-30

Force-height diagram

Purchase order data

Type	Order No.
Rubber bellows only	61789
Bellows with bead rings, 1 7/8 bolts, nuts and washers	62271

Additional types on request

Technical data

Min. pressure	0 psi
Return force to min. height	≤ 157 lbs
Overall weight with bead rings, bolts, nuts and washers	34 lbs

Vibration isolation - dynamic characteristic values

Design height H: recommended 10.5 inch, minimum 9.6 inch

Pressure p [psi]	40	60	80	100	120		Vol. V [in ³]
Force (Load) [lbs]	16700	25050	33400	41750	50100		4884
Spring rate [lbs/in]	4058	5817	7420	8734	10452		
Natural frequency [Hz]	1.5	1.5	1.5	1.4	1.4		

Pneumatic application - static characteristic values

Force F [lbs]

Pressure p [psi]	20	40	60	80	100	120	Vol [in ³]	
Height H [in]	12	7130	14270	21400	28540	35670	42810	5521
	10	8640	17290	25930	34570	43210	51860	4647
	8	9640	19280	28930	38570	48210	57850	3702
	6	10230	20460	30690	40920	51150	61370	2657
	4	10580	21170	31750	42330	52920	63500	1560



Service instructions

3/8-24 UNF = 28-32 LBxFT