

FD 44-10

CONTI® Double Convolution Air Spring

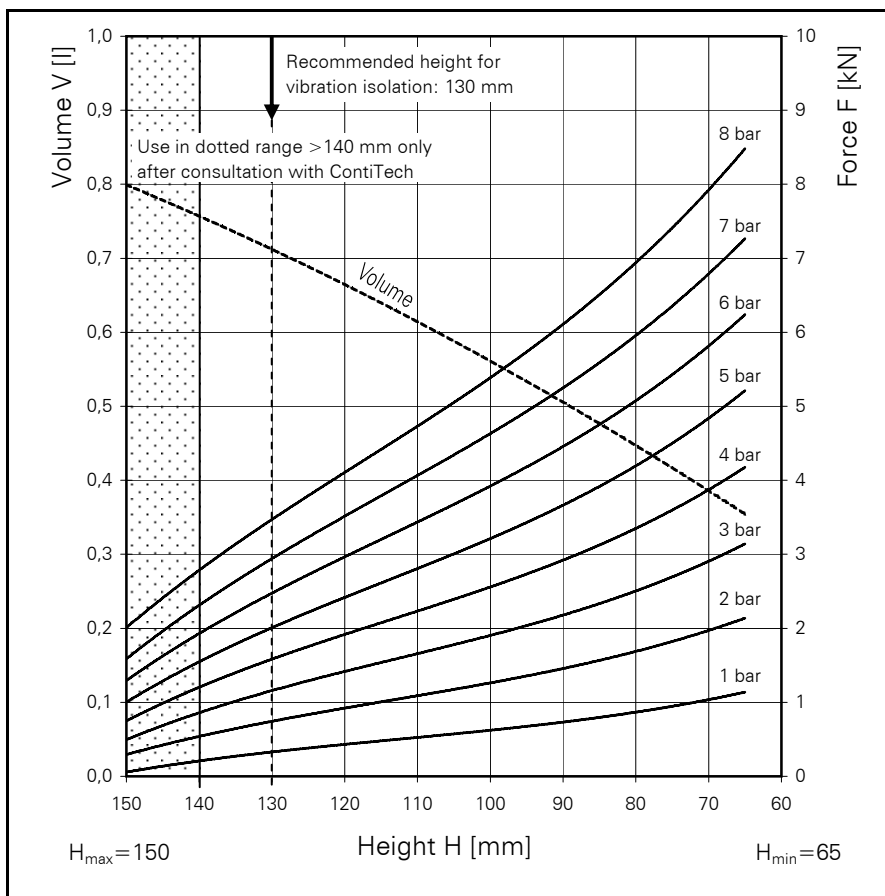
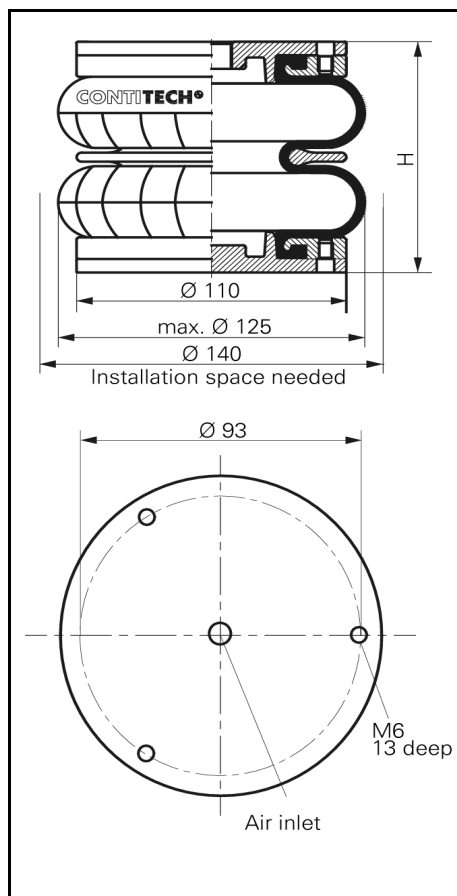

FD 44-10

Force-height diagram

Purchase order data

Type	Order No.
Rubber bellows only	on request
With removable plates and G 3/8 air inlet	50586

Additional types on request

Technical data

Min. pressure	0 bar
Return force to min. height	≤ 130 N
Overall weight with clamped plates	0.9 kg

Vibration isolation - dynamic characteristic values

Design height H: recommended 130mm, minimum 110mm

Pressure p [bar]	3	4	5	6	7	8	Vol. V[l]
Force (Load) [kN]	1.2	1.7	2.1	2.5	3.0	3.4	
Spring rate [N/cm]	425	545	661	775	895	1010	
Natural frequency [Hz]	3.0	2.9	2.8	2.8	2.7	2.7	

Pneumatic application - static characteristic values

Force F [kN]

Pressure p [bar]	3	4	5	6	7	8	Vol.[l]	
Height H [mm]	140	0.9	1.2	1.6	1.9	2.3		0.76
	125	1.3	1.8	2.2	2.7	3.2		0.68
	110	1.7	2.2	2.8	3.5	4.1		0.61
	100	1.9	2.6	3.2	3.9	4.7		0.56
	90	2.2	2.9	3.7	4.5	5.3		0.51
	80	2.5	3.4	4.2	5.1	5.9		0.45
	70	2.9	3.8	4.8	5.8	6.7		0.39



Service instructions
M6 = 5 Nm
G 3/8 = 15 Nm

