

FD 816-30

CONTI® Double Convolution Air Spring

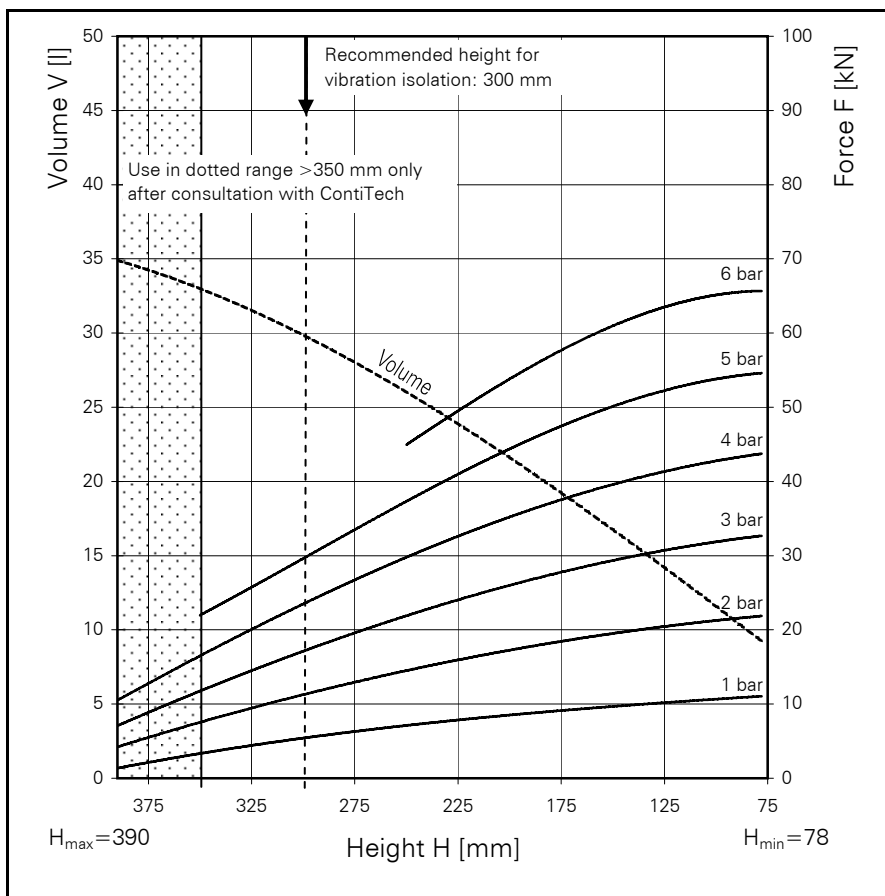
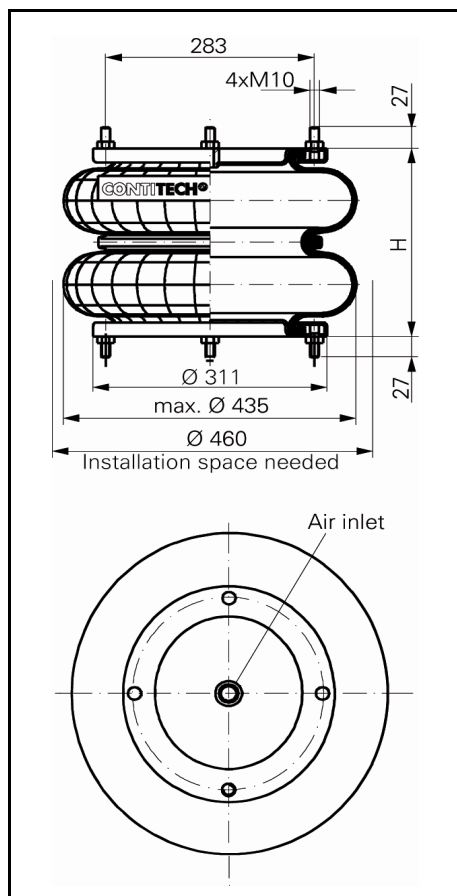

FD 816-30

Force-height diagram

Purchase order data

Type	Order No.
Rubber bellows only	50696
With removable plates and G 1/2 air inlet	50694

Additional types on request

Technical data

Min. pressure	0 bar
Return force to min. height	≤ 80 N
Overall weight with metal plates	9.5 kg

Vibration isolation - dynamic characteristic values

Design height H: recommended 300mm, minimum 280mm

Pressure p [bar]	3	4	5	6	7	8	Vol V[l]
Force (Load) [kN]	18.0	24.3	30.7	37.0	-	-	
Spring rate [N/cm]	1720	2195	2665	3145	-	-	
Natural frequency [Hz]	1.5	1.5	1.5	1.5	-	-	

Pneumatic application - static characteristic values

Force F [kN]

Pressure p [bar]	3	4	5	6	7	8	Vol.[l]	
Height H [mm]	350	12.0	16.9	21.8	-	-		33.3
	300	17.4	23.8	30.2	-	-		30.0
	250	21.5	29.2	36.9	45.0	-		25.8
	200	25.8	35.0	44.2	53.7	-		21.3
	150	29.8	40.1	50.5	61.1	-		17.0
	100	32.0	42.9	53.8	65.0	-		12.0
	78	32.5	43.5	54.5	65.8	-		8.9



Service instructions

M10 = 25 Nm

G 1/2 = 25 Nm