

FT 614-36

CONTI® Triple Convolution Air Spring

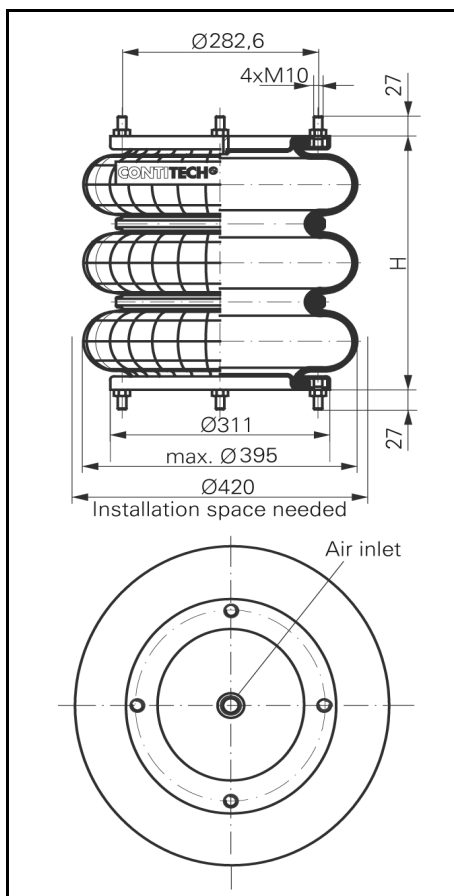

FT 614-36

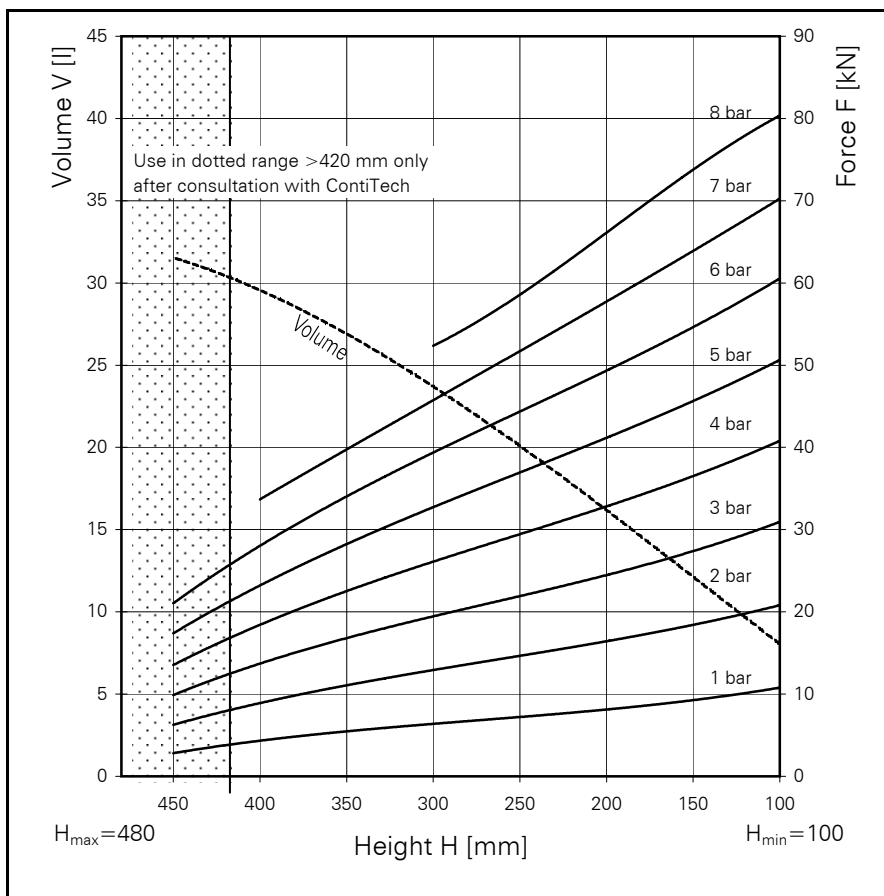

Force-height diagram

Purchase order data

Type	Order No.
Rubber bellows only	50665
With removable plates and G 1/2 air inlet	50662

Technical data

Min. pressure	0 bar
Return force to min. height	≤290 N
Overall weight with metal plates	11.5 kg

Additional types on request

Pneumatic application - static characteristic values

Force F [kN]

Pressure p [bar]	3	4	5	6	7	8	Vol.[l]	
Height H [mm]	400	13.8	18.6	23.5	28.4	33.4	38.6	29.5
	350	17.0	22.8	28.5	34.4	40.4	46.4	27.0
	300	19.5	26.0	32.6	39.2	45.8	52.4	23.8
	250	21.3	28.8	36.2	43.4	50.8	58.4	20.0
	200	24.8	33.2	41.6	49.8	58.0	66.4	16.2
	150	27.6	36.8	46.0	55.2	64.4	73.6	12.2
	100	30.8	40.6	50.4	60.2	70.0	80.4	8.0



Service instructions

M10 = 25 Nm

G 1/2 = 25 Nm