

SK 37-8 P02

CONTI® Sleeve Type Air Spring

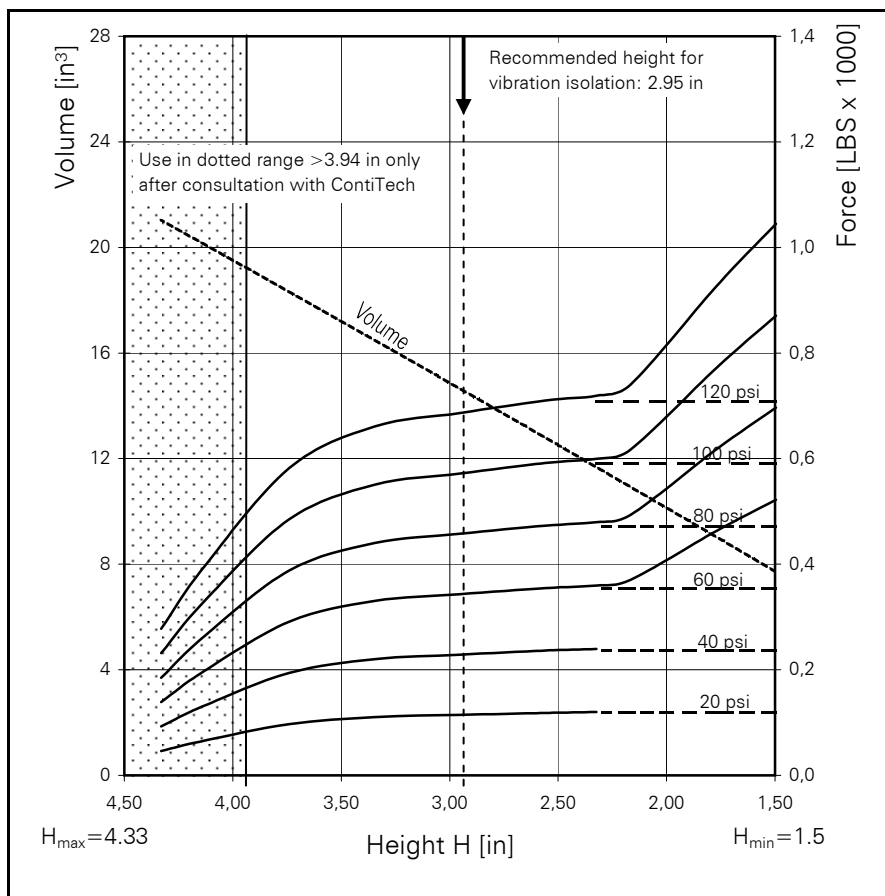
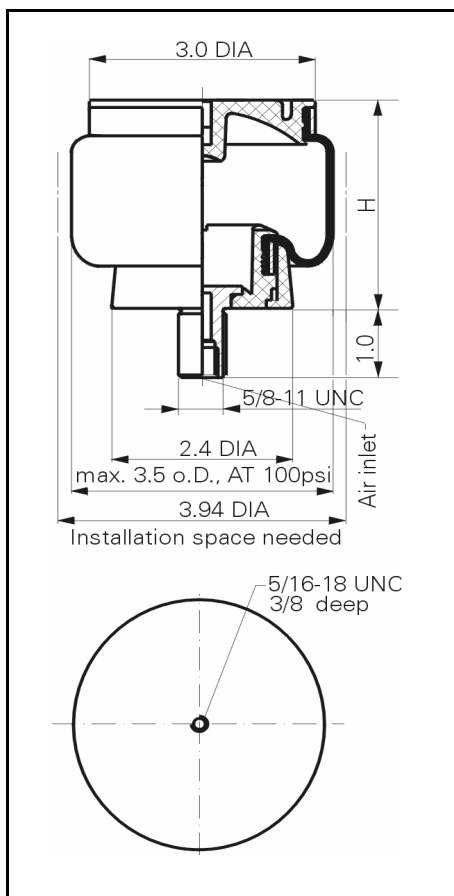

SK 37-8 P02

Force-height diagram

Purchase order data

| | |
|------------------------------------|-----------|
| Type | Order No. |
| With 1/8 NPT air inlet, brass stud | 63239 |

Technical data

| | |
|------------------------------------|----------|
| Min. pressure | 0 psi |
| Return force to min. height | ≤ 34 lbs |
| Overall weight with clamped plates | 0.66 lbs |

Note:

The dotted lines on the static load curves shows the force of the SK 37-8 with an additional 0.6inch. pedestal under the piston. This pedestal is NOT provided by ContiTech. If this pedestal is not used, the the bellow will contact the ground at a height of approx. 2.2inch. This should be avoided because it could cause wear at the bellow. Minimum pressure for service without pedestal is 45psi.

Vibration isolation - dynamic characteristic values

Design height H: recommended 2.95 inch, lateral guidance necessary

| | | | | | | | |
|------------------------|-----|-----|-----|-----|-----|--|---------------------------|
| Pressure p [psi] | 40 | 60 | 80 | 100 | 120 | | Vol. V [in ³] |
| Force (Load) [lbs] | 230 | 340 | 460 | 570 | 690 | | 15 |
| Spring rate [lbs/in] | 159 | 221 | 272 | 310 | 363 | | |
| Natural frequency [Hz] | 2.7 | 2.5 | 2.4 | 2.3 | 2.3 | | |

Pneumatic application - static characteristic values

| | | | | | | | | |
|------------------|-----|-----|-----|-----|-----|-----|------------------------|------|
| Force F [lbs] | | | | | | | | |
| Pressure p [psi] | 20 | 40 | 60 | 80 | 100 | 120 | Vol [in ³] | |
| Height H [in] | 3.5 | 100 | 210 | 310 | 420 | 520 | 630 | 17.2 |
| | 3 | 110 | 230 | 340 | 460 | 570 | 680 | 14.9 |
| | 2.5 | 120 | 240 | 360 | 470 | 590 | 710 | 12.5 |



Service instructions

5/16-18 UNC = 2-4 LBxFT

5/8-11 UNC = 8-10 LBxFT

1/8 NPT = Handtight plus one turn